

# RXC20 SERIES

High Voltage Contactors

**200A** CONTINUOUS DUTY

**1000V** SYSTEM VOLTAGE



## FEATURES

### SPST Normally Open High Voltage Contactors

- Hermetic ceramic seal with gas fill
- Meets RoHS 2011/65/EU
- High temperature performance
- CE certified



**PERFORMANCE**

TABLE 1. SPECIFICATIONS				
CHARACTERISTIC		MEASURE		
Contact Arrangement		Form X, SPST NO		
Max Switching Voltage		1000 VDC		
Dielectric Withstand Voltage Contacts to Coil		3000 VAC, 1 minute		
Dielectric Withstand Voltage Across Open Contacts		4000 VDC, 1 minute		
Continuous Current (53mm <sup>2</sup> conductor)		200A		
Overload Current	30 seconds	900A		
	3 Minutes	400A		
Make and Break		See table		
Max Short Circuit Current -1 second		1500 A		
Min Insulation Resistance		1000 MOhm @ 1,000V		
Contact Resistance (typical)		0.15 mOhm		
Operate Time (Max, incl bounce)		25ms		
Release Time (Max)		10ms		
Shock - Functional, 1/2 Sine, 11ms		20G		
Shock – Destructive, 1/2 Sine, 11ms		50G		
Operating Temperature		-40°C to 100°C (180°C max terminal temperature)		
Ingress Protection		Exceeds IP69, (Hermetically sealed)		
Mechanical life		300,000		
COIL @ 20°C		MEASURE		
Nominal Voltage		12V	24V	48V
Pick-up Voltage (Max)		8.5 VDC	17.0 VDC	38.4 VDC
Drop-out Voltage (Min)		0.6 VDC	0.9 VDC	3.3 VDC
Holding Current		0.46A	0.25A	0.12A
Coil Resistance +/- 5%		26Ω	100Ω	392Ω
Coil Power		5.5W	5.8W	6W

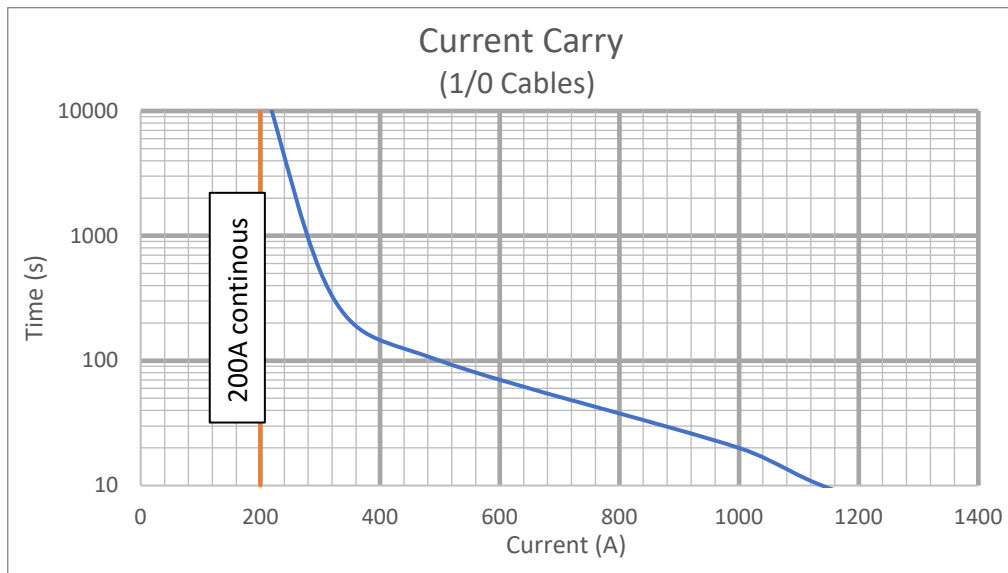

TABLE 2. RESISTIVE LOAD SWITCHING (MAKE / BREAK DATA)		
POLARITY SENSITIVE VERSION		CYCLES (1 cycle = 1 make + 1 break)
VOLTAGE	CURRENT	
750V	20A	20,000
750V	100A	1,000
750V	300A	2
900V	100A	100
450V	100A	7,500

- 85C ambient
- 150C max terminal Temp
- 1/0 Cables
- Single pulse
- Graph provided for design reference; user to verify system temperatures

**OPTIONS**

TABLE 3. PRODUCT NOMENCLATURE				
		MOUNTING	COIL	AUXILIARY CONTACTS
RXC14	P Polarity Sensitive	1 Bottom Mount	A 12V single coil	X None
			B 24V single coil	
			C 48V single coil	

**PRODUCT DIMENSIONS [mm]**

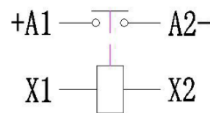
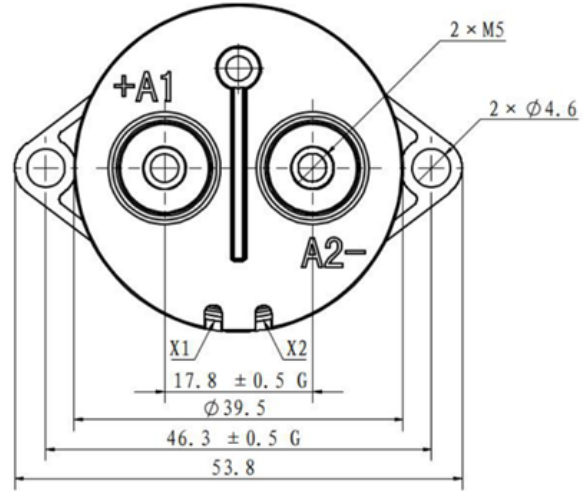
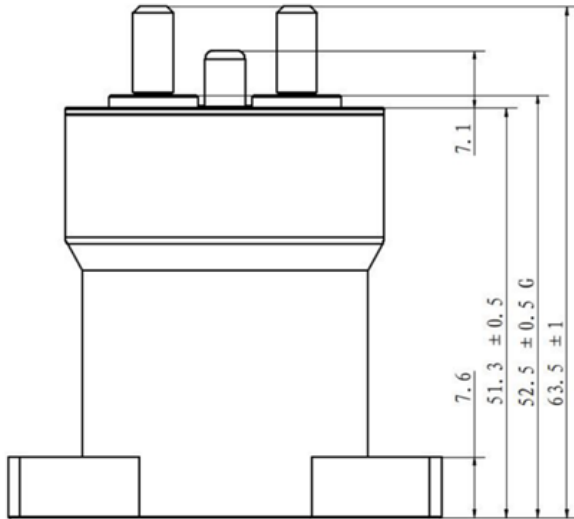

TABLE 4. DIMENSIONAL AND INSTALLATION	
CHARACTERISTIC	MEASURE
Weight	185g (0.41 lb)
Mounting Position	Any / Not Position Sensitive
Package Quantity	30
Install Torque M5 Main Terminals	3-4Nm (26-36 in-lb)
Mounting Torque, M4 hardware	2.3Nm
Power Terminal Pad Material	Copper
Housing Material	Zytel FR50

**NOTES**

- Polarity Sensitive versions are marked +A1 and -A2 for the power terminals. For applications that require the contactor under load, please ensure current is flowing from the +A1 to the -A2 terminal when breaking/opening under load For Bi-Directional versions the direction of current does not matter when breaking under load
- Attached cables and busbars directly to the main terminal pad using the recommended install torque. Do not use washers or other materials between the contactor and the conductor. This will ensure the lowest possible contact resistance
- Avoid excessive coil voltages. Exceeding the ratings on the datasheet may result in high coil temperature and coil failure
- Contactor may be used above Max Switching Voltage if the application does not require significant load breaking. Please contact Rincon Power to discuss in more detail

### Legal Disclaimer Notice for Rincon Power, LLC Datasheet

This legal disclaimer applies to purchasers and users of products manufactured by or on behalf of Rincon Power, LLC ("Rincon"). Unless otherwise expressly indicated in writing, Rincon's products, product specifications and data sheets relating thereto are subject to change without notice. Users should check for and obtain the latest revision information and verify that such information is current and complete before placing orders for Rincon's products. Users should always verify the actual performance of the Rincon's products in their specific systems and applications.

Except as expressly set forth in the relevant purchaser order terms and conditions or applicable agreement, Rincon makes no warranty, representation or guarantee regarding the products, expressed or implied, including, but not limited to, a warranty of merchantability or fitness for a particular purpose. To the maximum extent permitted by applicable law, Rincon disclaims (i) any and all liability arising out of the application or use of any product, (ii) any and all liability, including without limitation special, consequential or incidental damages, and (iii) any and all implied warranties, including warranties of fitness for particular purpose, non-infringement and merchantability.

In no event shall Rincon be liable for any incidental or consequential damages resulting from the use, misuse or inability to use the product. This exclusion applies regardless of whether such damages are sought based on breach of warranty, breach of contract, negligence, strict liability in tort, or any other legal theory.